



**Shaw  
& Co**  
ESTATE  
AGENTS

**£279,950**

**Meadow View, Hithermoor**

Staines-Upon-Thames, TW19 6BH

**Shaw  
& Co**



## Meadow View

Approximate Gross Internal Area  
452 sq ft - 42 sq m

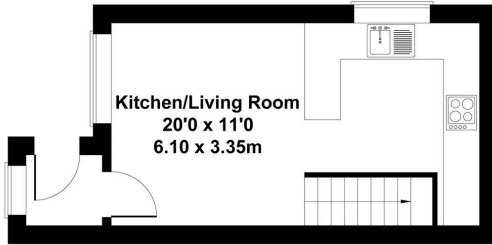

GROUND FLOOR

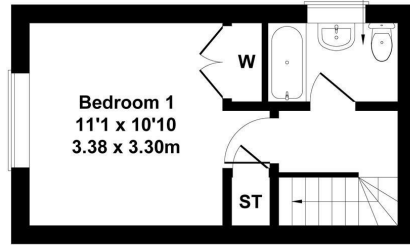

FIRST FLOOR

Not to Scale. Produced by The Plan Portal 2025  
For Illustrative Purposes Only.

Shaw  
& Co



Energy Efficiency Rating		
	Current	Potential
Very energy efficient - lower running costs		
(92 plus) <b>A</b>		
(81-91) <b>B</b>		
(69-80) <b>C</b>		
(55-68) <b>D</b>		
(39-54) <b>E</b>		
(21-38) <b>F</b>		
(1-20) <b>G</b>		
Not energy efficient - higher running costs		
<b>England &amp; Wales</b>	EU Directive 2002/91/EC	



Shaw  
& Co



Shaw  
& Co

Agents Note: Whilst every care has been taken to prepare these particulars, they are for guidance purposes only. All measurements are approximate and are for general guidance purposes only and whilst every care has been taken to ensure their accuracy, they should not be relied upon and potential buyers/tenants are advised to recheck the measurements

**Shaw  
& Co**  
ESTATE  
AGENTS

OFFICE ADDRESS  
Whitton  
Twickenham  
TW2 7LT

OFFICE DETAILS  
0208 894 3646  
whitton@shawandcoestates.com